

[img.1]

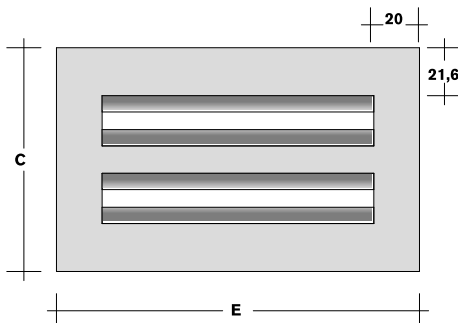

[img.2]

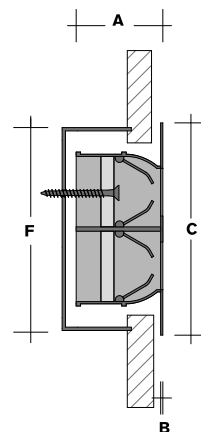

[img.3]

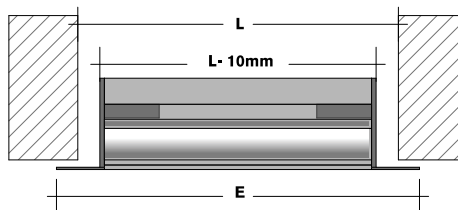

[img.4]

[img.1] corte vertical 2 vias
coupe verticale 2 fentes
vertical cross-section 2 slots
corte vertical 2 vias

[img.2] alçado frente 2 vias
vue de face 2 fentes
front view 2 slots
vista frontal 2 vias

[img.3] corte vertical 2 vias
coupe verticale 2 fentes
vertical cross-section 2 slots
corte vertical 2 vias

[img.4] corte horizontal com P/M
coupe horizontale avec P/M
horizontal cross-section with P/M DL
corte horizontal con P/M DL

dimensões de fabrico
dimensions de fabrication manufacturing dimensions
dimensiones de fabricación

(L)

min.: 100 mm

max.: 2500mm

vias/ fentes slots vias	A	B	C	D	E	F
1	40 mm	1,3 mm	64 mm	40 mm	L+30 mm	50 mm
2	40 mm	1,3 mm	98 mm	74 mm	L+30 mm	85 mm
3	40 mm	1,3 mm	130 mm	106 mm	L+30 mm	117 mm
4	40 mm	1,3 mm	164 mm	140 mm	L+30 mm	150 mm